

# 480 FLY



# 480 FLY



Scan to see the video

## ULTIMATE JOY OF EXPLORATION

The 480 FLY exemplifies Galeon's pursuit of innovation and luxury in the 2024 lineup, integrating a refined design with practical functionality. Its spacious layout prioritizes comfort and social engagement, boasting features that elevate the onboard experience. Like its larger counterpart, the 500 FLY, the 480 FLY includes an open-concept main deck with seamless access between the salon and the cockpit, ensuring a cohesive indoor-outdoor experience.

The flybridge on the Galeon 480 FLY offers two seating areas, a second helm station, and a wet bar for perfect entertaining. A stylish carbon fiber bimini adds optional protection from the elements., perfect for entertaining or relaxing under the optional carbon fiber bimini. The Beach Mode expands the cockpit area to allow greater access to the sea, enhancing the feeling of openness and freedom.

The 480 FLY provides a choice of cockpit arrangements, allowing owners to select between a 360-degree rotating sofa for versatile seating or a traditional layout with a crew cabin.

The interior is thoughtfully divided, with a generous lounge and dining area connected to a fully equipped kitchen, complete with modern appliances for effortless entertaining.

Accommodating up to six guests, the lower deck features a luxurious master suite, a VIP cabin forward, and a twin guest cabin. Each stateroom offers ample storage and large windows for natural light, ensuring a tranquil retreat for all on board. With customizable options for interior finishes and engine configurations, the 480 FLY allows owners to tailor their yacht to match their personal style and cruising needs.

Embodying the spirit of exploration, the 480 FLY merges Galeon's signature craftsmanship with innovative features, making it a standout vessel in the world of luxury yachts.



## FLYBRIDGE LINE

*The spacious flybridge on the 480 FLY is a harmonious blend of functionality and style, where both the captain and guests can comfortably spend time, enjoying the comfortable seating and a practical bar with a grill.*





# 480 FLY

Seamless integration of indoor and outdoor spaces and total command the yacht from up top.



The roto-seat option allows the cockpit seating to face any direction —



A sizable flybridge will fit all guests in comfort —



*LIGHT WALNUT*

A range of bespoke design options lets you personalize every detail to match your unique style

**480** FLY



A lounge and entertainment area with a retractable TV —



The galley comes fully equipped and can serve the outside bar —



The bright VIP cabin offers ample storage —

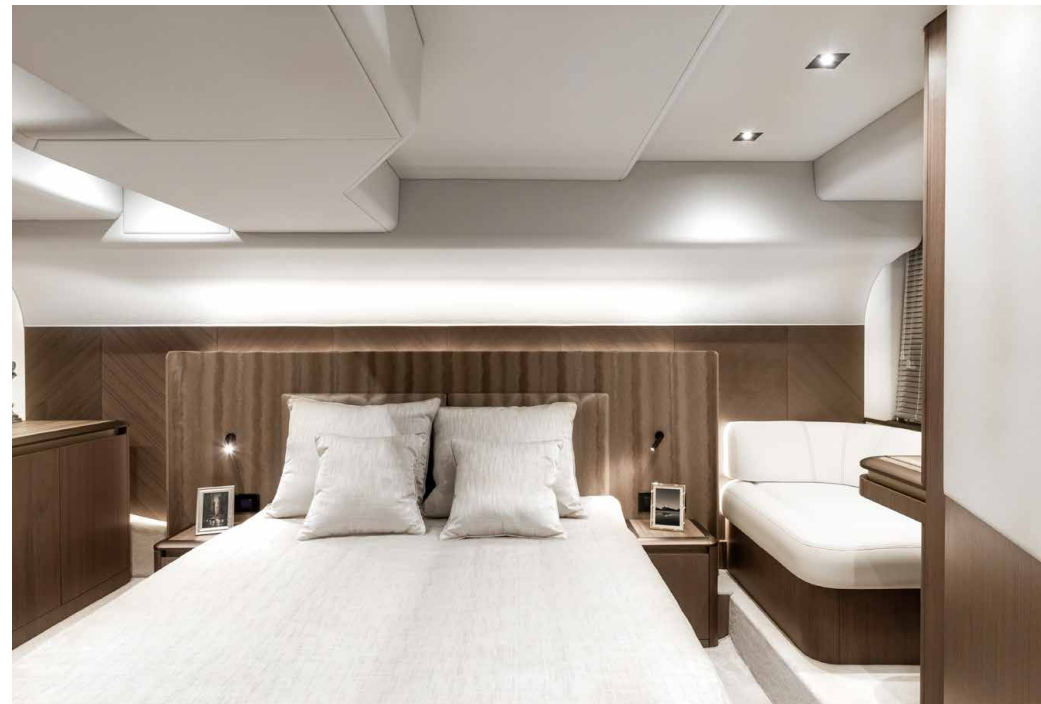

Master stateroom with en suite bathroom and rest area —



— Quickly drop the back rests and stow away the table for cruising



— The seat rotates 360°

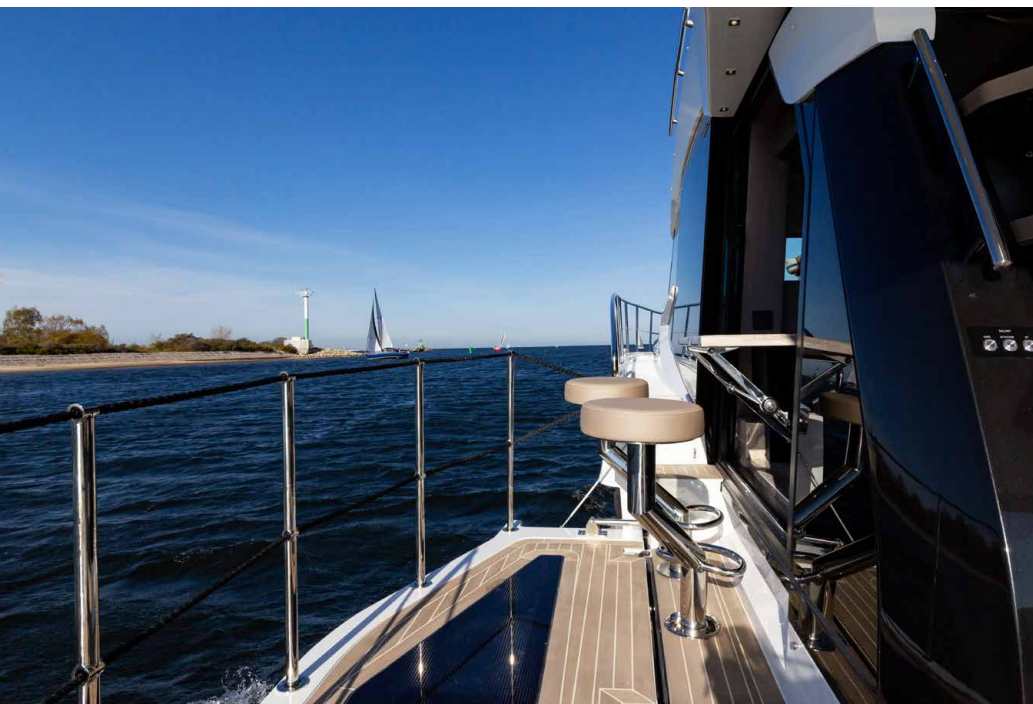

— Serve refreshments to the outside bar to impress the guests



— Incredible cockpit area with the balconies down



# 480 FLY

2024 LAYOUTS

## TECHNICAL SPECIFICATION

Length of the hull	[m]	<b>12,9</b>	[ft]	<b>42'4"</b>
Length overall	[m]	<b>14,35</b>	[ft]	<b>47'1"</b>
Beam of the hull	[m]	<b>4,33</b>	[ft]	<b>14'2"</b>
Beam overall	[m]	<b>5,94</b>	[ft]	<b>19'6"</b>
Draft max. (canoe body)	[m]	<b>1,3</b>	[ft]	<b>4'3"</b>
Fuel tank capacity	[dm3]	<b>2 x 750</b>	[USGal]	<b>2x 198</b>
Water tank capacity	[dm3]	<b>650</b>	[USGal]	<b>172</b>
Mass of Light Craft Condition	[kg]	<b>18752</b>	[lbs]	<b>41341</b>
Maximum load	[kg]	<b>4072</b>	[lbs]	<b>8977</b>
Min. engine (-s) power	[kW/HP]	<b>2 x 328 / 440</b>		
Max. engine (-s) power	[kW/HP]	<b>2 x 447 / 600</b>		
Crew limit		<b>14</b>		
Category		<b>B</b>		

### DISCLAIMER:

The yacht shown may include optional equipment that is not part of the standard model. Equipment availability and features may vary depending on the market.

**ULTIMATE JOY  
OF EXPLORATION**

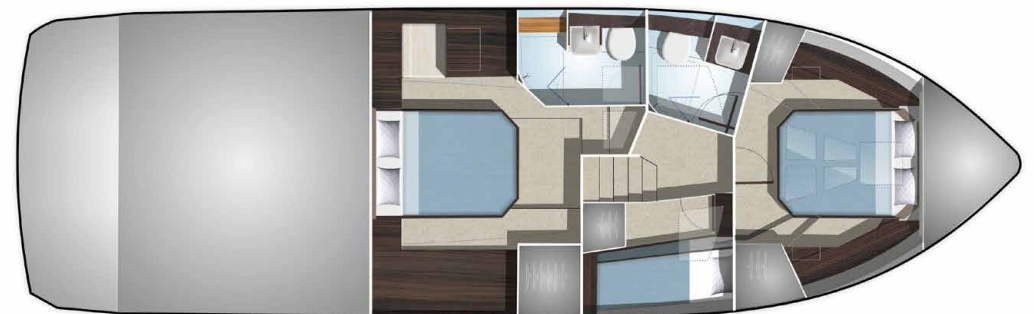

# 480 FLY



  
**GALEON**

[WWW.GALEON.PL](http://WWW.GALEON.PL)